



**Display unit for StecaGrid 3000, StecaGrid 3600, StecaGrid 8000 3ph and StecaGrid 10000 3ph**

**StecaGrid Vision**

One photovoltaic system – one display

The philosophy behind the StecaGrid Vision display unit is to provide the system operator with a representation of the entire system's data. In the default display, the output and yields of all connected StecaGrid inverters are shown as combined totals. Thus, the operator does not need to go from one inverter to the next, reading out the values individually and adding them up themselves. Naturally, it is also possible to view and compare data from individual inverters.



**Up to 20 inverters can be connected**

One to 20 StecaGrid inverters can be connected to the optional StecaGrid Vision display unit. The wired connections between the inverters and to the display unit are realised via Steca's own communication bus.

**Easy to operate**

The StecaGrid Vision impresses with its design. It is operated by means of four modern capacitive buttons. Graphic curves show the energy yields from the system as a whole, and from individual inverters, thus providing information at a glance, regarding the performance over the course of the day. In addition, StecaGrid Vision has a data logging function, which also enables querying of historical data. Error messages regarding the system as a whole, as well as individual inverters, are shown in plain text.

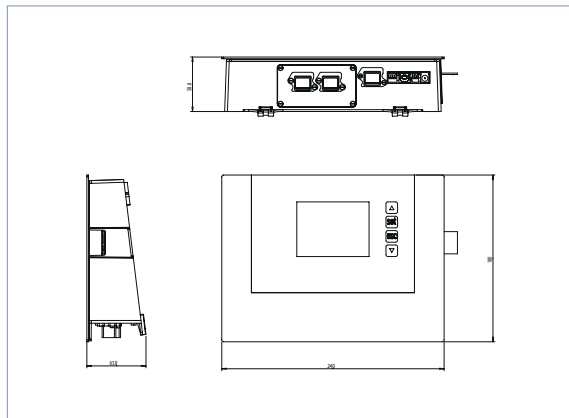

**Product features**

- Integrated data logger
- Self-test feature for Italy

**Display**

- Multifunction graphic LCD display with backlighting
  - for current output, energy yields, operating parameters, date, time, service information
- Animated representation of yield

**Operation**

- Multilingual menu navigation

StecaGrid Vision	
<b>Application conditions</b>	
Area of application	indoor rooms, with or without air conditioning
Interface to inverter	Steca bus with max. 1,000 m cable length
Ambient temperature	-20 °C ... +45 °C
Humidity	0 % ... 95 %
Noise emissions in standard operating conditions	silent
<b>Equipment and design</b>	
Protection class	IP 20
Dimensions (X x Y x Z)	240 x 180 x 63.8 mm
Weight	450 g
Power supply	230 V mains adapter plug (included in delivery)
Communication interface	USB, optional ethernet
Range	1,000 m
Test certificate	CE mark

**Interconnection**

StecaGrid 10 000 3ph, StecaGrid 8000 3ph, StecaGrid 3000 and StecaGrid 3600 inverters with StecaGrid Vision display unit:



StecaGrid Vision + StecaGrid 10 000 3ph + StecaGrid 8000 3ph + StecaGrid 8000 3ph + StecaGrid 3000 + StecaGrid 3600